

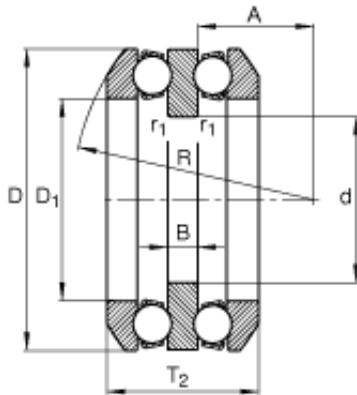

# BEARING BOWER CORP.

## 55 mm x 125 mm x 16 mm FAG 54314 Thrust Ball Bearing

Bearing No. 54314



54314 Bearing 2D drawings and 3D CAD models

Size	55x125x80.4 mm
Bore Diameter	55 mm
Outer Diameter	125 mm
Width	80,4 mm
d	55 mm
D	125 mm
T <sub>2</sub>	80,4 mm
A	39 mm
B	16 mm
D <sub>1</sub>	72 mm
D <sub>a max</sub>	98 mm
d <sub>a max</sub>	70 mm
R	100 mm
r <sub>1 min</sub>	1 mm
r <sub>a max</sub>	1 mm
r <sub>a1 max</sub>	1 mm
r <sub>min</sub>	1,1 mm
m	3,77 kg / Weight
C <sub>a</sub>	134000 N / Dynamic load rating (axial)
C <sub>0a</sub>	290000 N / Static load rating (axial)
A	0,5 / Factor min. load
n <sub>G</sub>	2750 1/min / Limiting speed
C <sub>ua</sub>	12900 N / Fatigue limit load,



# BEARING BOWER CORP.

	axial
--	-------