

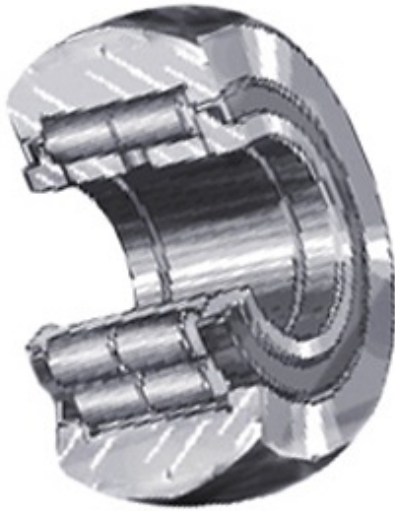

BEARING BOWER CORP.

25 mm x 62 mm x 25 mm SKF NUTR 2562 A Cam Follower and Track Roller - Yoke Type



Bearing No. NUTR 2562 A

NUTR 2562 A Bearing 2D drawings and 3D CAD models

Category	Cam Follower and Track Roller - Yoke Type
Inventory	0.0
Manufacturer Name	SKF
Minimum Buy Quantity	N/A
Weight	0.45
EAN	7316570169874
Product Group	B04120
Roller Surface Profile	Crowned
Profile	Yoke Type
Enclosure	Sealed
Rolling Element	Cylindrical Roller Bearing - Double Row
Relubricatable	Yes
Inch - Metric	Metric
Other Features	Full Complement With Flanged Inner Ring Labyrinth Seal
Long Description	25MM Bore; 62MM Roller Diameter; 24MM Roller Width; Crowned Roller; Yoke Type; Sealed; Cylindrical Roller Bearing - Double Row; Relubricatable
Category	Cam Followers Yoke Type
UNSPSC	31171530
Harmonized Tariff Code	8482.50.00.00
Noun	Bearing



BEARING BOWER CORP.

Keyword String	Cam Follower
Manufacturer URL	http://www.skf.com
Manufacturer Item Number	NUTR 2562 A
Weight / LBS	0.992
Roller Diameter	2.441 Inch 62 Millimeter
Roller Width	0.945 Inch 24 Millimeter
d	0.984 Inch 25 Millimeter
roller diameter:	62 mm
radial dynamic load capacity:	35.8 kN
roller width:	24 mm
radial static load capacity:	48 kN
bore diameter:	25 mm
roller material:	Steel
roller shape:	Crowned
maximum rpm:	3200 rpm
bearing element:	Cylindrical Rollers
finish/coating:	Uncoated
overall width:	25 mm
manufacturer catalog:	Click here
closure type:	Sealed
series:	NUTR
operating temperature range:	300 ° F
manufacturer upc number:	7316570169874
D	62 mm
d	25 mm
C	24 mm
B	25 mm
d ₁	31 mm
r _{1,2} min.	1 mm
r, r _{3,4} min.	0.5 mm
Basic dynamic load rating C	35.8 kN



BEARING BOWER CORP.

Basic static load rating C_0	48 kN
Fatigue load limit P_u	5.6 kN
Maximum dynamic radial loads F_r max.	44 kN
Maximum static radial loads F_{0r} max.	63 kN
Limiting speed	3200 r/min
Mass support roller	0.45 kg